

slimline invisible 16/3

PRODUCT IMAGE



TECHNICAL DATA

product description: Decorative acoustic panel for walls and ceilings for mounting on substructure.

dimension: 2.784 x 192 mm

slotting: 16/3 (45° oblique)

core-board: 19 mm MDF B2 E1
drilled

surface: veneer | CPL | melamine

fire classification: C-s2, d0 acc. DIN EN 13501-1 (in composite)
limited contribution to fire (others on request)

edges: longitudinal : tongue and groove system
transverse : industrial saw cut

mounting: vertical | horizontal
wall | ceiling

accessories: mounting-clip (optional)

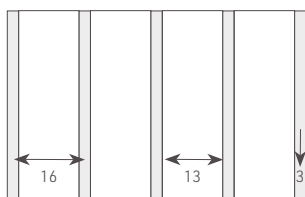

slotting:
3 mm slot + 13 mm slat

PROVISIONAL NOTE:

This data sheet has been prepared to the best of our knowledge and belief. No liability can be assumed for printing and standard errors as well as errors. Due to (product) further development, there may be changes to the available data. The content of this data sheet should not be used as a legally binding basis.

SOUND ABSORPTION VALUES

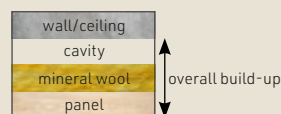

overall build-up	49 mm	79 mm
cavity (open)	-	-
mineral wool	30 mm	60 mm
panel thickness	19 mm	19 mm
frequency [Hz]	α_s	α_s
100	0,11	0,24
125	0,18	0,41
160	0,31	0,69
200	0,47	0,88
250	0,61	1,04
315	0,78	1,06
400	0,90	1,04
500	1,00	1,01
630	1,03	0,98
800	1,00	0,88
1000	0,98	0,89
1250	0,95	0,88
1600	0,84	0,84
2000	0,81	0,83
2500	0,72	0,79
3150	0,64	0,67
4000	0,64	0,61
5000	0,58	0,57
α_w	0,80	0,80
absorber class	B	B

